

FORGED GLOBE VALVES

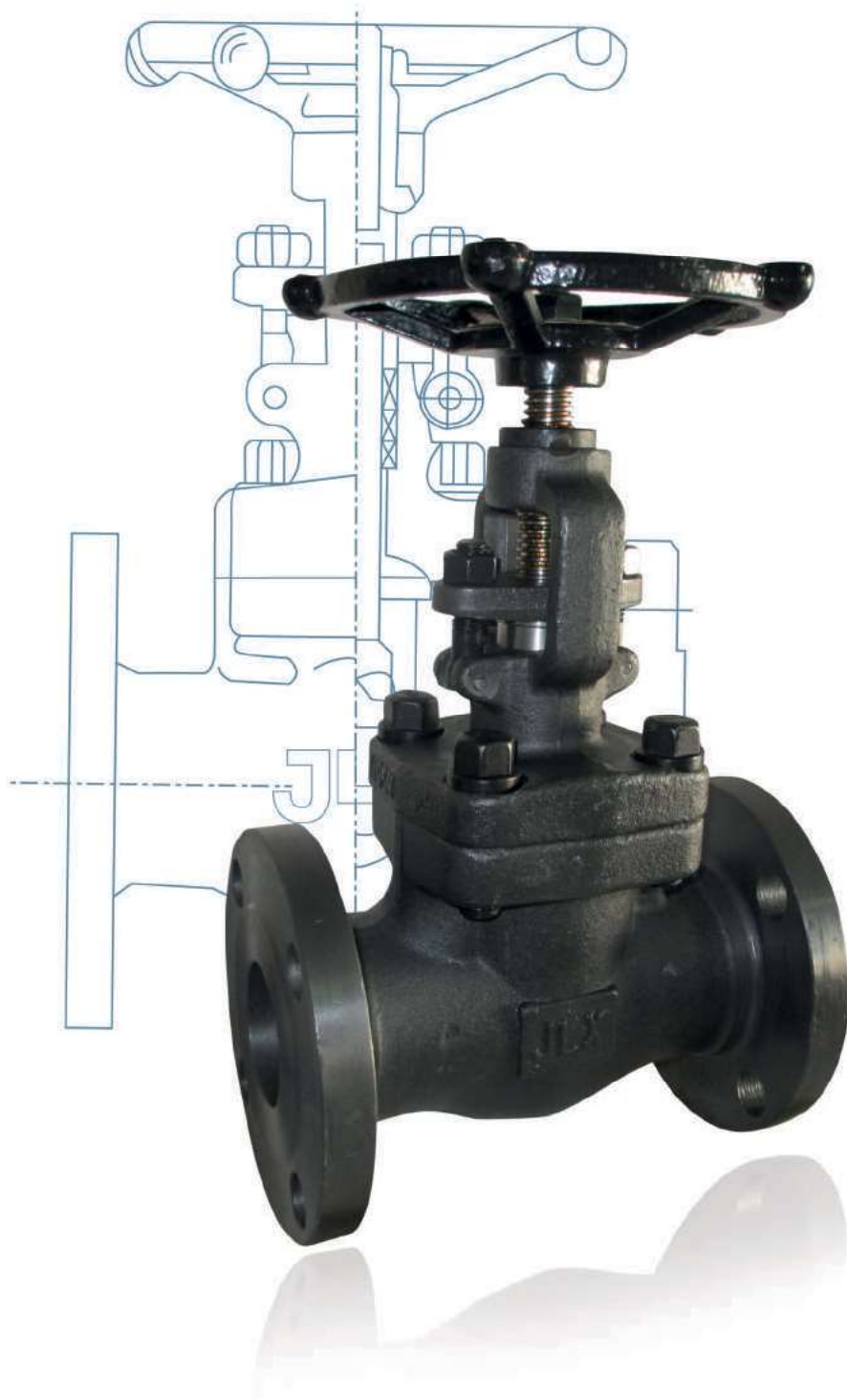

FORGED GLOBE VALVES

1/4" - 3" | Class 800 - Class 1500

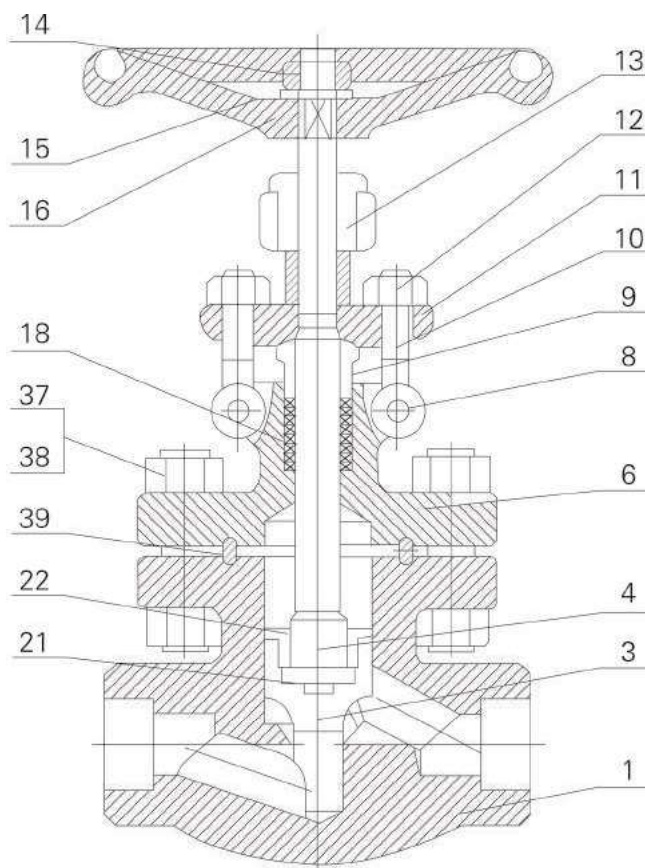

BILL OF MATERIALS

Item	Description	A105/F6a	LF2/304	F11/F6aHF	F22/F6aHF	F304(L)/304(L)	F316(L)/316(L)	F51/F51
1	Body	A105	LF2	F11+HF	F22+HF	F304(L)	F316(L)	F51
3	Disc	F6a	F304	F6aHF	F6aHF	F304(L)	F316(L)	F51
4	Stem	410	304	410	410	304(L)	316(L)	F51
6	Bonnet	A105	LF2	F11	F22	F304(L)	F316(L)	F51
8	Pin	410	410	410	410	304	304	304
9	Gland	410	304	410	410	304	316	F51
10	Gland eyebolt	B7	L7	B16	B16	B8(M)	B8(M)	B8M
11	Gland Flange	A1 05	LF2	F11	F22	F304	F304	F304
12	Hex nut	2H	2H	2H	2H	8(M)	8(M)	8M
13	Stem nut	410	410	410	410	410	410	410
14	Locking nut	35	35	35	35	35	35	35
15	Nameplate	AL	AL	AL	AL	AL	AL	AL
16	Handwheel	A197	A197	A197	A197	A197	A197	A197
18	Packing	Graphite	Graphite	Graphite	Graphite	Graphite	Graphite	Graphite
21	Stem pad	420	420	420	420	316SH	316SH	316SH
22	Disc nut	410	410	410	410	410	410	410
37	Screwed stud	B7	L7	B16	B16	B8(M)	B8(M)	B8(M)
38	Nut	2H	8	8	8	8(M)	8(M)	8(M)
39	Metal ring	304	304	304	304	304(L)	316(L)	F51

* Standard construction with trim 8,2 and 10. Others constructions are available.
(1) Zinc coating.

FORGED GLOBE VALVES

PRESENTATION

Globe valve are closing-down valves in which the closure member is moved squarely on and off the seat. In this way the opening of the port is directly proportional to the travel of the disc. This proportional relationship is ideally suited for duties requiring regulation of flow rate. To have a further precision in regulation the disc element can be available in the parabolic, needle, veeport types.

Furthermore the short travel of the disc between the open and closed position makes these valves ideally suited for on-off duties when they must be opened and closed frequently. Globe valves are unidirectional valves and are installed so that fluid pressure is under the disc. They are supplied in various models to cover the different services. Among these valves the Bellows sealed combines the characteristics of total safety against leakages to the easy substitution of the most delicate components such as the bellows.



HIGHLIGHTS

Body and Bonnet

Bodies and bonnets are high quality forged and afterwards precisely revised, directing the attention to prevent stress concentration.

As standard stock, the bodies of globe valves consist of a reduced bore Port. Under request we can delivery also Full bore port that guarantees minimal turbulence and resistance to flow. It is available the option with bolted bonnet or also welded bonnet and also bellows sealed design.



Standards

Design and manufacture conform to API 602, BS5352 & ASME 16.34.

Connections ends conform to

1. Socket Weld ends acc. ANSI B16.11.
2. Threaded ends acc. ANSI B1.20.1.
3. Butt weld ends acc. ANSI B16.25.
4. Flanged ends acc. ANSI B16.5 or EN-DIN.

Test and inspection conform API598.

Structure features

1. Bolted bonnet outside screw and yoke (OS & Y).
2. Welded bonnet outside screw and yoke (OS & Y).

Material conform to ANSI / ASTM

Main materials: A105, LF2, F5, F11, F22, 304(L) 316(L), F347, F321, F51. Also exotics materials as MONEL, ALLOY20.

PRESSURE & TEMPERATURE 800 lbs

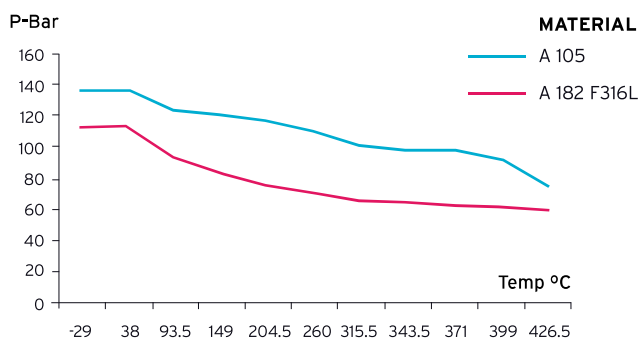

PRESSURE & TEMPERATURE 1500 lbs

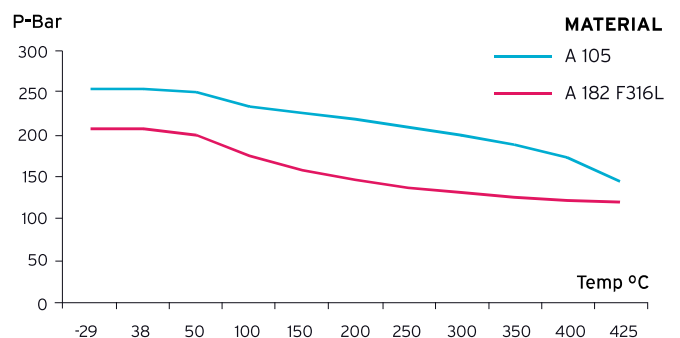

FORGED GLOBE VALVES

FORGED GLOBE VALVE API 602, BS5352 & ASME B16.34

Class 800

Sizes 3/8" to 2"

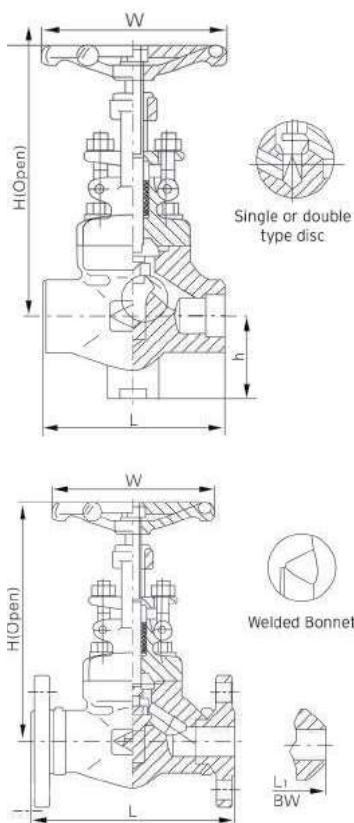

Carbon steel and alloy steel construction

Stainless steel construction

TRIM

API 600 TRIM N°	Nominal TRIM	Stem / Backseat	Seating Surface Body / Wedge
1	F6	13Cr	13Cr
2	304	18Cr-8Ni	18Cr-8Ni
3	F310	25Cr-20Ni	25Cr-20Ni
4	Hard F6	13Cr	Hard 13Cr
5	Hardfaced	13Cr	Co-Cr A
5A	Hardfaced	13Cr	Ni-Cr
6	F6 and Cu-Ni	13Cr	13Cr and Cu-Ni
7	F6 and Hard F6	13Cr	13Cr and Hard 13Cr
8	F6 and Hardfaced	13Cr	13Cr and Co-Cr A
8A	F6 and Hardfaced	13Cr	13Cr and Ni-Cr
9	Monel	Ni-Cu Alloy	Ni-Cu Alloy
10	316	18Cr-8Ni-Mo	18Cr-8Ni-Mo
11	Monel and Hardfaced	Ni-Cu Alloy	Ni-Cu Alloy and Trim 5 or 5A
12	316 and Hardfaced	18Cr-8Ni-Mo	18Cr-8Ni-Mo and Trim 5 or 5A
13	Alloy 20	19Cr-29Ni	19Cr-29Ni
14	Alloy 20 and Hardfaced	19Cr-29Ni	19Cr-29Ni and Trim 5 or 5A
15	Hardfaced	18Cr-8Ni	Co-Cr A
16	Hardfaced	18Cr-8Ni-Mo	Co-Cr A
17	Hardfaced	18Cr-10Ni-Cb	Co-Cr A
18	Hardfaced	19Cr-29Ni	Co-Cr A

HF: Hard Facing using CoCr welding alloy (Stellite)

GENERAL DIMENSIONS 800LB SW AND NPT ENDS

DN		L	H (OPEN)	W	WEIGHTS	
REDUCED BORE	FULL BORE				BOLTED BONNET	WELDED BONNET
3/8"	-	79	166	100	1.9	1.7
1/2"	3/8"	79	166	100	1.9	1.7
3/4"	1/2"	92	171	100	2.1	1.9
1"	3/4"	111	207	125	3.5	3.3
1 1/4"	1"	120	240	160	6.0	5.2
1 1/2"	1 1/4"	152	258	160	7.5	6.8
2"	1 1/2"	172	330	180	11.4	10.6
-	2"	200	355	200	14.6	13.8

GENERAL DIMENSIONS 800LB 150/300 RF ENDS & PN40

DN		L				WEIGHTS			
REDUCED BORE	FULL BORE	150#	300#	600#	PN40	150#	300#	600#	PN40
1/2"	1/2"	108	152	165	130	3.4	3.77	5.6	3.77
3/4"	3/4"	117	178	190	150	3.98	5.1	7.8	5.1
1"	1"	127	203	216	160	6.12	7.23	12.5	7.23
1 1/4"	1 1/4"	140	216	229	180	9.6	12	17	12
1 1/2"	1 1/2"	165	229	241	200	10.5	13.5	23.5	13.5
2"	2"	203	267	292	230	17	19.7	38.8	19.7

Dimensions in mm and weight in kg.
Weights and dimensions can be changed without notice.
Bigger sizes available under customer request.

FORGED GLOBE VALVES

FORGED GLOBE VALVE API 602, BS5352 & ASME B16.34 Class 1500

Sizes 1/2" to 2"

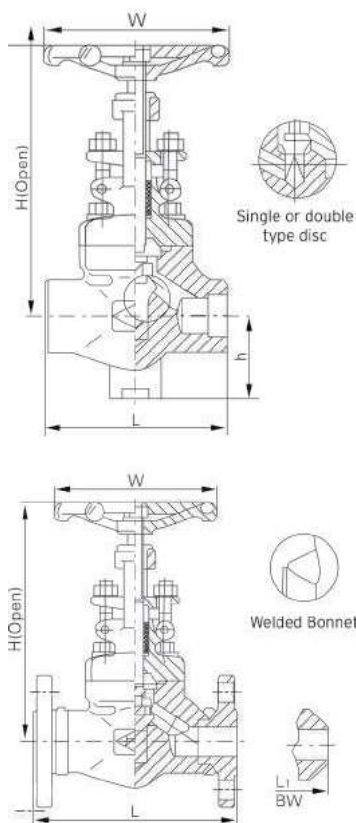

Carbon steel and alloy steel construction

Stainless steel construction

TRIM

API 600 TRIM N°	Nominal TRIM	Stem / Backseat	Seating Surface Body / Wedge
1	F6	13Cr	13Cr
2	304	18Cr-8Ni	18Cr-8Ni
3	F310	25Cr-20Ni	25Cr-20Ni
4	Hard F6	13Cr	Hard 13Cr
5	Hardfaced	13Cr	Co-Cr A
5A	Hardfaced	13Cr	Ni-Cr
6	F6 and Cu-Ni	13Cr	13Cr and Cu-Ni
7	F6 and Hard F6	13Cr	13Cr and Hard 13Cr
8	F6 and Hardfaced	13Cr	13Cr and Co-Cr A
8A	F6 and Hardfaced	13Cr	13Cr and Ni-Cr
9	Monel	Ni-Cu Alloy	Ni-Cu Alloy
10	316	18Cr-8Ni-Mo	18Cr-8Ni-Mo
11	Monel and Hardfaced	Ni-Cu Alloy	Ni-Cu Alloy and Trim 5 or 5A
12	316 and Hardfaced	18Cr-8Ni-Mo	18Cr-8Ni-Mo and Trim 5 or 5A
13	Alloy 20	19Cr-29Ni	19Cr-29Ni
14	Alloy 20 and Hardfaced	19Cr-29Ni	19Cr-29Ni and Trim 5 or 5A
15	Hardfaced	18Cr-8Ni	Co-Cr A
16	Hardfaced	18Cr-8Ni-Mo	Co-Cr A
17	Hardfaced	18Cr-10Ni-Cb	Co-Cr A
18	Hardfaced	19Cr-29Ni	Co-Cr A

HF: Hard Facing using CoCr welding alloy (Stellite)

GENERAL DIMENSIONS 1500LB SW AND NPT ENDS

DN		L	H (OPEN)	W	WEIGHTS	
REDUCED BORE	FULL BORE				BOLTED BONNET	WELDED BONNET
3/8"	-	92	171	100	2.2	2.0
1/2"	3/8"	111	207	125	3.7	3.4
3/4"	1/2"	111	207	125	3.6	3.3
1"	3/4"	120	240	160	6.8	6.0
1 1/4"	1"	152	258	160	7.6	5.6
1 1/2"	1 1/4"	172	330	180	11.6	10.3
2"	1 1/2"	220	355	200	15.0	14.2
-	2"	220	370	240	21.9	18.0

GENERAL DIMENSIONS 1500LB 1500 RF/RTJ ENDS & PN63/100

DN		L		WEIGHT
REDUCED BORE	FULL BORE	1500 LB	PN63/100	
1/2"	-	216	210	15.5
3/4"	-	229	230	16.9
1"	-	254	230	18.9
1 1/4"	-	279	260	28.9
1 1/2"	-	305	260	34.3
2"	-	368	300	52.8

Dimensions in mm and weight in kg.
Weights and dimensions can be changed without notice.
Bigger sizes available under customer request.